

# PHARMA<sub>L</sub>ok™

## Tube Clamps

Pharmalok™ tube clamps effortlessly and securely close off flow. Thin-walled tube clamps fit wall thicknesses 1/32" (0.79 mm) to 3/32" (2.38 mm) with a maximum OD of 1/2" (12.7 mm). Tube clamps fit wall thicknesses 1/8" (3.2 mm) to 1/4" (6.4 mm) with a maximum OD of 1" (25.4 mm). Large tube clamps fit wall thicknesses 1/8" (3.2 mm) to 1/4" (6.4 mm) with a maximum OD of 2.5" (63.5 mm).

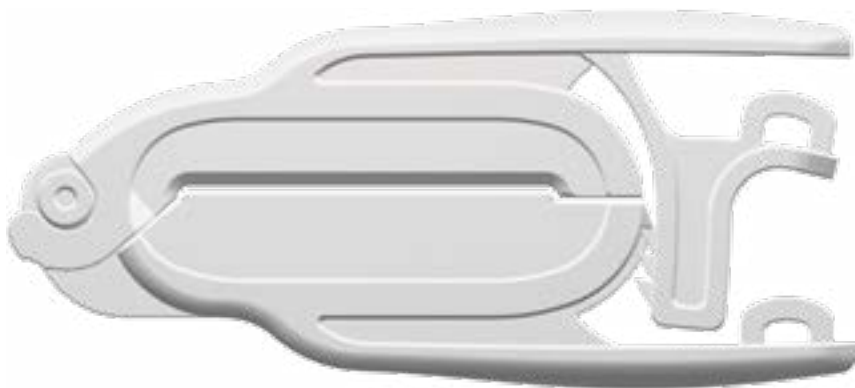

### **CPT90 (-U71 -U706)**

PharmaLok™ Small and Thin-Walled Tube Clamp, Wall Thickness 1/32" (0.79 mm) to 3/32" (2.4 mm), Max OD 1/2" (12.7 mm), Glass-Filled White Nylon or Glass-Reinforced Orange Nylon

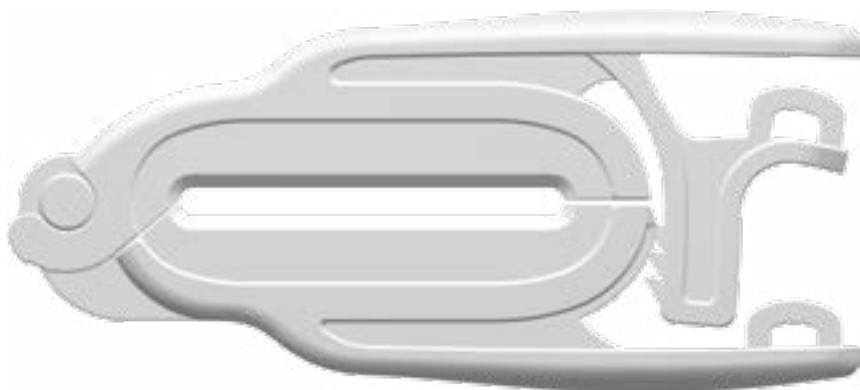

### **CPT100 (-U71 -U706)**

PharmaLok™ Tube Clamp, Wall Thickness 1/8" (3.2 mm) to 1/4" (6.4 mm), Max OD 1" (25.4 mm), Glass-Filled White Nylon or Glass-Reinforced Orange Nylon

## Tube Clamps

### Features & Benefits:

- Designed for use with silicone & TPE tubing
- Easy to use, one-handed closure - no tools needed
- Tamper evident & zip tie compatible

## Tube Clamps

### Specifications:

#### Materials:

- USP Class VI & ISO 10993 certified glass-filled nylon

#### Temperature & Sterilization Specifications:

- Normal operating temperature -94°F (-70°C) to 140°F (60°C)
- Cryogenic freezing to -112°F (-80°C)
- Autoclavable up to 273°F (134°C) for a maximum of 30 min.
- Gamma radiation up to 50 kGy

#### Maximum Pressure:

- Up to 150 psi

#### Sizes:

- Thin-walled, tube clamp, and large sizes



### CPT110 (-U71 -U706)

PharmaLok™ Large Tube Clamp, Wall Thickness 1/8" (3.2 mm) to 1/4" (6.4 mm), Max OD 2.5" (63.5 mm), Glass-Filled White Nylon or Glass-Reinforced Orange Nylon

### Need it Fast?

You can order any of our 5,000+ parts online now with no order \$ minimums, 24 hours a day, 7 days a week!  
[www.nordsonmedical.com](http://www.nordsonmedical.com)